

# 地積測量図 縮尺 1:400

所在 富山市上二杉 地内

令和 3年12月28日 測量

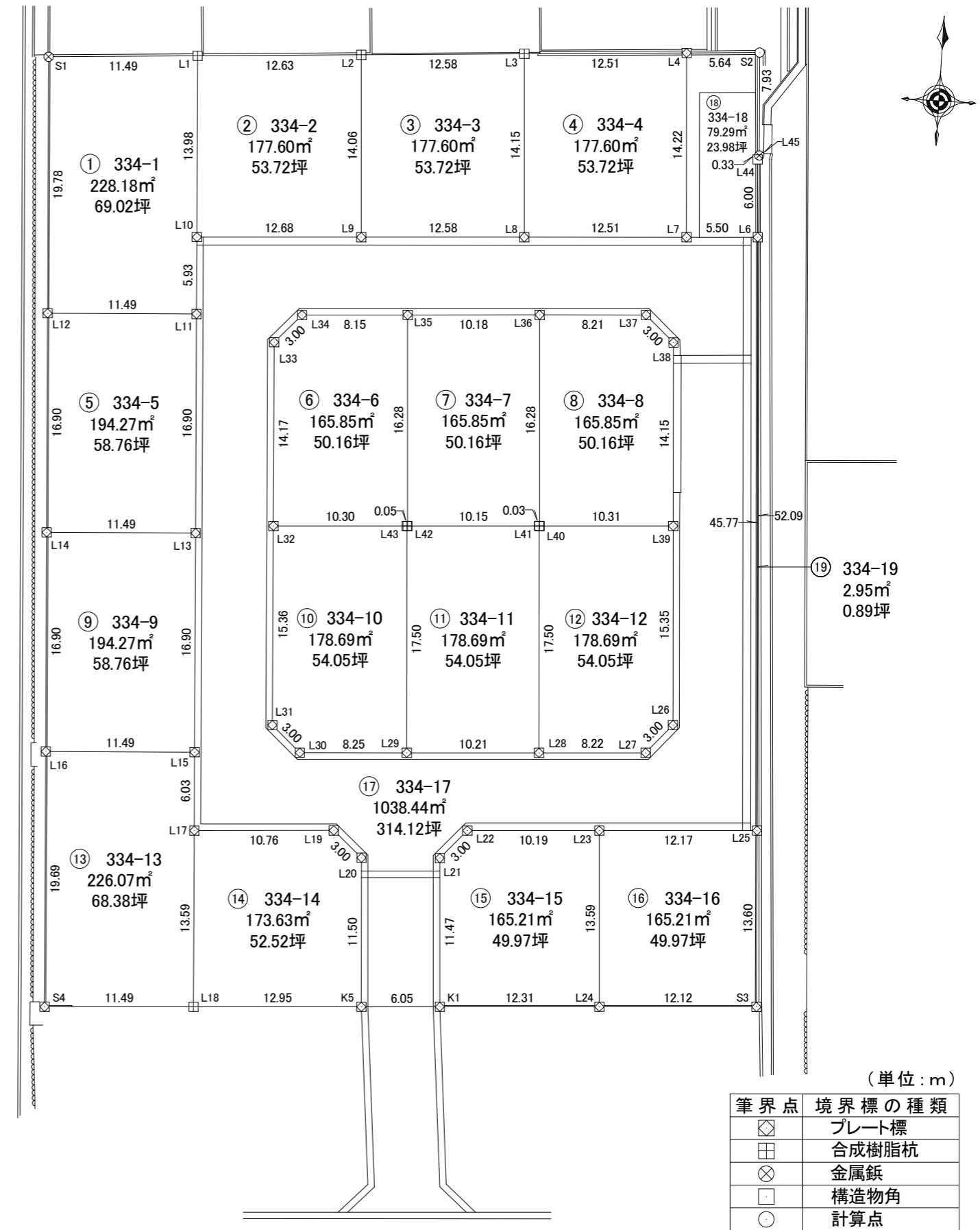

(単位:m)

筆界点	境界標の種類
◇	プレート標
⊕	合成樹脂杭
⊗	金属鈹
□	構造物角
○	計算点

富山県砺波市杉木246番地4

土地家屋調査士 吉 森 茂

求積表

地番 ① 334-1				
NO	Xn	Yn	Yn+1-Yn-1	Xn · (Yn+1-Yn-1)
S1	594.453	467.294	10.313	6130.593789
L1	595.246	478.763	12.285	7312.597110
L10	581.283	479.579	1.161	674.869563
L11	575.363	479.924	-11.129	-6403.214827
L12	574.701	468.450	-12.630	-7258.473630
合計				456.372005
合計面積				228.1860025
地積				228.18 m <sup>2</sup>

地番 ② 334-2				
NO	Xn	Yn	Yn+1-Yn-1	Xn · (Yn+1-Yn-1)
L1	595.246	478.763	11.787	7016.164602
L2	596.116	491.366	13.480	8035.643680
L9	582.074	492.243	-11.787	-6860.906238
L10	581.283	479.579	-13.480	-7835.694840
合計				355.207204
合計面積				177.6036020
地積				177.60 m <sup>2</sup>

地番 ③ 334-3				
NO	Xn	Yn	Yn+1-Yn-1	Xn · (Yn+1-Yn-1)
L2	596.116	491.366	11.679	6962.038764
L3	596.984	503.922	13.438	8022.270992
L8	582.858	504.804	-11.679	-6807.198582
L9	582.074	492.243	-13.438	-7821.910412
合計				355.200762
合計面積				177.6003810
地積				177.60 m <sup>2</sup>

地番 ④ 334-4				
NO	Xn	Yn	Yn+1-Yn-1	Xn · (Yn+1-Yn-1)
L3	596.984	503.922	11.609	6930.387256
L4	597.832	516.413	13.375	7996.003000
L7	583.638	517.297	-11.609	-6775.453542
L8	582.858	504.804	-13.375	-7795.725750
合計				355.210964
合計面積				177.6054820
地積				177.60 m <sup>2</sup>

地番 ⑤ 334-5				
NO	Xn	Yn	Yn+1-Yn-1	Xn · (Yn+1-Yn-1)
L11	575.363	479.924	12.458	7167.872254
L13	558.486	480.908	-10.488	-5857.401168
L14	557.825	469.436	-12.458	-6949.383850
L12	574.701	468.450	10.488	6027.464088
合計				388.551324
合計面積				194.2756620
地積				194.27 m <sup>2</sup>

地番 ⑥ 334-6				
NO	Xn	Yn	Yn+1-Yn-1	Xn · (Yn+1-Yn-1)
L33	573.564	486.040	1.188	681.394032
L34	575.795	488.054	10.151	5844.895045
L35	576.308	496.191	9.151	5273.794508
L42	560.059	497.205	0.957	535.976463
L43	560.055	497.148	-10.339	-5790.408645
L32	559.411	486.866	-11.108	-6213.937388
合計				331.714015
合計面積				165.8570075
地積				165.85 m <sup>2</sup>

地番 ⑦ 334-7				
NO	Xn	Yn	Yn+1-Yn-1	Xn · (Yn+1-Yn-1)
L35	576.308	496.191	9.151	5273.794508
L36	576.950	506.356	11.180	6450.301000
L40	560.696	507.371	0.980	549.482080
L41	560.694	507.336	-10.166	-5700.015204
L42	560.059	497.205	-11.145	-6241.857555
合計				331.704829
合計面積				165.8524145
地積				165.85 m <sup>2</sup>

地番 ⑧ 334-8				
NO	Xn	Yn	Yn+1-Yn-1	Xn · (Yn+1-Yn-1)
L36	576.950	506.356	7.186	4145.962700
L37	577.458	514.557	10.445	6031.548810
L38	575.466	516.801	3.109	1789.123794
L39	561.342	517.666	-9.430	-5293.455060
L40	560.696	507.371	-11.310	-6341.471760
合計				331.708484
合計面積				165.8542420
地積				165.85 m <sup>2</sup>

地番 ⑨ 334-9				
NO	Xn	Yn	Yn+1-Yn-1	Xn · (Yn+1-Yn-1)
L14	557.825	469.436	10.488	5850.468600
L13	558.486	480.908	12.456	6956.501616
L15	541.605	481.892	-10.488	-5680.353240
L16	540.949	470.420	-12.456	-6738.060744
合計				388.556232
合計面積				194.2781160
地積				194.27 m <sup>2</sup>

地番 ⑩ 334-10				
NO	Xn	Yn	Yn+1-Yn-1	Xn · (Yn+1-Yn-1)
L32	559.411	486.866	-9.396	-5256.225756
L31	544.070	487.752	3.134	1705.115380
L30	542.079	490.000	10.485	5683.698315
L29	542.586	498.237	7.148	3878.404728
L43	560.055	497.148	-11.371	-6368.385405
合計				-357.392738
合計面積				178.6963690
地積				178.69 m <sup>2</sup>

地番 ⑪ 334-11				
NO	Xn	Yn	Yn+1-Yn-1	Xn · (Yn+1-Yn-1)
L43	560.055	497.148	1.032	577.976760
L29	542.586	498.237	11.281	6120.912666
L28	543.227	508.429	9.099	4942.822473
L41	560.694	507.336	-11.224	-6293.229456
L42	560.059	497.205	-10.188	-5705.881092
合計				-357.398649
合計面積				178.6993245
地積				178.69 m <sup>2</sup>

地番 ⑫ 334-12				
NO	Xn	Yn	Yn+1-Yn-1	Xn · (Yn+1-Yn-1)
L28	543.227	508.429	9.306	5055.270462
L27	543.743	516.642	10.177	5533.672511
L26	546.011	518.606	1.024	559.115264
L39	561.342	517.666	-11.235	-6306.677370
L40	560.696	507.371	-10.330	-5791.989680
L41	560.694	507.336	1.058	593.214252
合計				-357.394561
合計面積				178.6972805
地積				178.69 m <sup>2</sup>

地番 ⑬ 334-13				
NO	Xn	Yn	Yn+1-Yn-1	Xn · (Yn+1-Yn-1)
L15	541.605	481.892	11.823	6403.395915
L17	535.576	482.243	1.143	612.163368
L18	522.001	483.035	-10.684	-5577.058684
S4	521.283	471.559	-12.615	-6575.985045
L16	540.949	470.420	10.333	5589.626017
合計				452.141571
合計面積				226.0707855
地積				226.07 m <sup>2</sup>

地番 ⑭ 334-14				
NO	Xn	Yn	Yn+1-Yn-1	Xn · (Yn+1-Yn-1)
L17	535.576	482.243	9.952	5330.052352
L19	536.255	492.987	13.010	6976.677550
L20	534.288	495.253	2.979	1591.643952
K5	522.809	495.966	-12.218	-6387.680362
L18	522.001	483.035	-13.723	-7163.419723
合計				347.273769
合計面積				173.6368845
地積				173.63 m <sup>2</sup>

地番 ⑮ 334-15				
NO	Xn	Yn	Yn+1-Yn-1	Xn · (Yn+1-Yn-1)
L21	534.640	501.289	1.269	678.458160
L22	536.887	503.277	12.160	6528.545920
L23	537.526	513.449	11.025	5926.224150
L24	523.955	514.302	-11.441	-5994.569155
K1	523.186	502.008	-13.013	-6808.219418
合計				330.439657
合計面積				165.2198285
地積				165.21 m <sup>2</sup>

地番 ⑯ 334-16				
NO	Xn	Yn	Yn+1-Yn-1	Xn · (Yn+1-Yn-1)
L23	537.526	513.449	11.295	6071.356170
L25	538.290	525.597	12.954	6973.008660
S3	524.712	526.403	-11.295	-5926.622040
L24	523.955	514.302	-12.954	-6787.313070
合計				330.429720
合計面積				165.2148600
地積				165.21 m <sup>2</sup>

地番 ⑰ 334-17				
N0	Xn	Yn	Yn+1-Yn-1	Xn · (Yn+1-Yn-1)
L10	581.283	479.579	-8.130	-4725.830790
L11	575.363	479.924	1.329	764.657427
L13	558.486	480.908	1.968	1099.100448
L15	541.605	481.892	1.335	723.042675
L17	535.576	482.243	11.095	5942.215720
L19	536.255	492.987	13.010	6976.677550
L20	534.288	495.253	2.979	1591.643952
K5	522.809	495.966	6.755	3531.574795
K1	523.186	502.008	5.323	2784.919078
L21	534.640	501.289	1.269	678.458160
L22	536.887	503.277	12.160	6528.545920
L23	537.526	513.449	22.320	11997.580320
L25	538.290	525.597	9.338	5026.552020
L6	583.981	522.787	-8.300	-4847.042300
L7	583.638	517.297	-17.983	-10495.562154
L8	582.858	504.804	-25.054	-14602.924332
L9	582.074	492.243	-25.225	-14682.816650
L10	581.283	479.579	-4.189	-2434.994487
L34	575.795	488.054	16.612	9565.106540
L35	576.308	496.191	18.302	10547.589016
L36	576.950	506.356	18.366	10596.263700
L37	577.458	514.557	10.445	6031.548810
L38	575.466	516.801	3.109	1789.123794
L39	561.342	517.666	1.805	1013.222310
L26	546.011	518.606	-1.024	-559.115264
L27	543.743	516.642	-10.177	-5533.672511
L28	543.227	508.429	-18.405	-9998.092935
L29	542.586	498.237	-18.429	-9999.317394
L30	542.079	490.000	-10.485	-5683.698315
L31	544.070	487.752	-3.134	-1705.115380
L32	559.411	486.866	-1.712	-957.711632
L33	573.564	486.040	1.188	681.394032
L34	575.795	488.054	-6.461	-3720.211495
合計				-2076.889372
合計面積				1038.4446860
地積				1038.44 m <sup>2</sup>

総合計面積 4034.0473240 m<sup>2</sup>

地番	面積
① 334-1	228.1860025 m <sup>2</sup>
② 334-2	177.6036020 m <sup>2</sup>
③ 334-3	177.6003810 m <sup>2</sup>
④ 334-4	177.6054820 m <sup>2</sup>
⑤ 334-5	194.2756620 m <sup>2</sup>
⑥ 334-6	165.8570075 m <sup>2</sup>
⑦ 334-7	165.8524145 m <sup>2</sup>
⑧ 334-8	165.8542420 m <sup>2</sup>
⑨ 334-9	194.2781160 m <sup>2</sup>
⑩ 334-10	178.6963690 m <sup>2</sup>
⑪ 334-11	178.6993245 m <sup>2</sup>
⑫ 334-12	178.6972805 m <sup>2</sup>
⑬ 334-13	226.0707855 m <sup>2</sup>
⑭ 334-14	173.6368845 m <sup>2</sup>
⑮ 334-15	165.2198285 m <sup>2</sup>
⑯ 334-16	165.2148600 m <sup>2</sup>
⑰ 334-17	1038.4446860 m <sup>2</sup>
⑱ 334-18	79.2944020 m <sup>2</sup>
⑲ 334-19	2.9599940 m <sup>2</sup>

地番 ⑱ 334-18				
N0	Xn	Yn	Yn+1-Yn-1	Xn · (Yn+1-Yn-1)
L4	597.832	516.413	-4.744	-2836.115008
L7	583.638	517.297	6.374	3720.108612
L6	583.981	522.787	5.100	2978.303100
L44	589.977	522.397	-0.276	-162.833652
L45	590.289	522.511	-0.356	-210.142884
S2	598.214	522.041	-6.098	-3647.908972
合計				-158.588804
合計面積				79.2944020
地積				79.29 m <sup>2</sup>

地番 ⑲ 334-19				
N0	Xn	Yn	Yn+1-Yn-1	Xn · (Yn+1-Yn-1)
L45	590.289	522.511	-3.200	-1888.924800
L44	589.977	522.397	0.276	162.833652
L6	583.981	522.787	3.200	1868.739200
L25	538.290	525.597	-0.276	-148.568040
合計				-5.919988
合計面積				2.9599940
地積				2.95 m <sup>2</sup>