

地積測量図 縮尺 1:300

所在 富山市新庄町二丁目 地内

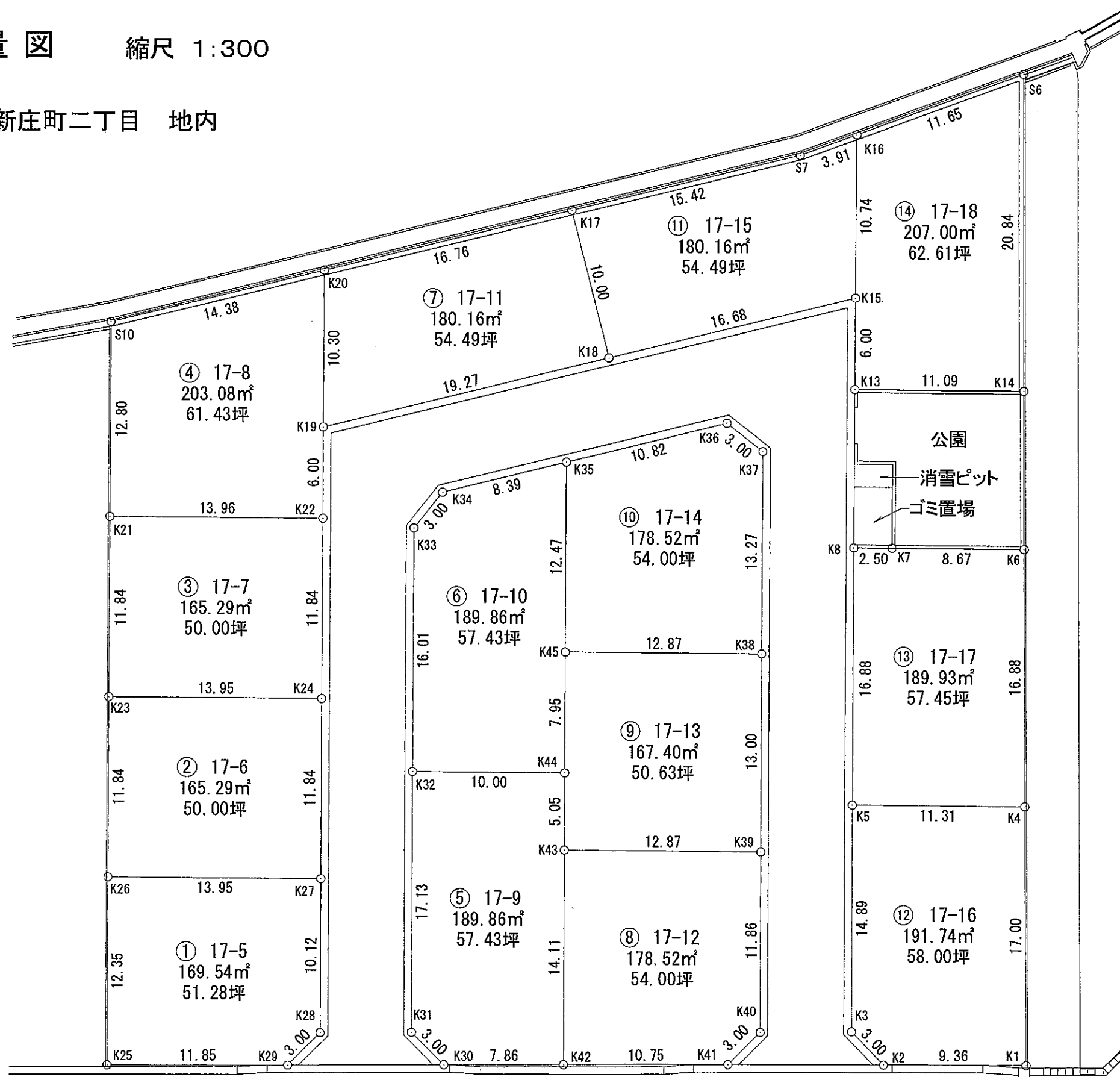
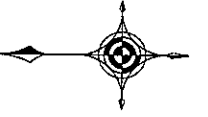

求積表

地番 ① 17-5				
NO	Xn	Yn	Yn+1-Yn-1	Xn · (Yn+1-Yn-1)
K25	77627.108	8025.114	12.259	951630.716972
K26	77627.116	8037.473	12.373	960480.306268
K27	77613.160	8037.487	-10.113	-784901.887080
K28	77613.151	8027.360	-12.273	-952546.202223
K29	77615.251	8025.214	-2.246	-174323.853746
合計				339.080191
合計面積				169.5400955
地積				169.54 m ²

地番 ② 17-6				
NO	Xn	Yn	Yn+1-Yn-1	Xn · (Yn+1-Yn-1)
K27	77613.160	8037.487	11.857	920259.238120
K24	77613.169	8049.330	11.832	918319.015608
K23	77627.124	8049.319	-11.857	-920424.809268
K26	77627.116	8037.473	-11.832	-918484.036512
合計				-330.592052
合計面積				165.2960260
地積				165.29 m ²

地番 ③ 17-7				
NO	Xn	Yn	Yn+1-Yn-1	Xn · (Yn+1-Yn-1)
K23	77627.124	8049.319	-11.830	-918328.876920
K24	77613.169	8049.330	11.852	919871.278988
K22	77613.167	8061.171	11.830	918163.765610
K21	77627.131	8061.160	-11.852	-920036.756612
合計				-330.588934
合計面積				165.2944670
地積				165.29 m ²

地番 ④ 17-8				
NO	Xn	Yn	Yn+1-Yn-1	Xn · (Yn+1-Yn-1)
K22	77613.167	8061.171	6.012	466610.360004
K19	77613.184	8067.172	16.304	1265405.351936
K20	77613.192	8077.475	6.794	527304.026448
S10	77627.139	8073.966	-16.315	-1266486.772785
K21	77627.131	8061.160	-12.795	-993239.141145
合計				-406.175542
合計面積				203.0877710
地積				203.08 m ²

地番 ⑤ 17-9				
NO	Xn	Yn	Yn+1-Yn-1	Xn · (Yn+1-Yn-1)
K30	77605.013	8025.322	2.031	157615.781403
K31	77607.149	8027.437	19.248	1493782.403952
K32	77607.166	8044.570	17.138	1330031.610908
K44	77597.165	8044.575	-5.053	-392098.474745
K43	77597.162	8039.517	-19.169	-1487459.998378
K42	77597.153	8025.406	-14.195	-1101491.586835
合計				379.736305
合計面積				189.8681525
地積				189.86 m ²

地番 ⑥ 17-10				
NO	Xn	Yn	Yn+1-Yn-1	Xn · (Yn+1-Yn-1)
K44	77597.165	8044.575	-7.955	-617285.447575
K32	77607.166	8044.570	16.005	1242102.691830
K33	77607.168	8060.580	18.378	1426264.533504
K34	77605.314	8062.948	4.422	343170.698508
K35	77597.177	8065.002	-10.423	-808795.375871
K45	77597.169	8052.525	-20.427	-1585077.371163
合計				379.729233
合計面積				189.8646165
地積				189.86 m ²

地番 ⑦ 17-11				
NO	Xn	Yn	Yn+1-Yn-1	Xn · (Yn+1-Yn-1)
K19	77613.184	8067.172	-5.604	-434944.283136
K18	77594.488	8071.871	14.396	1117050.249248
K17	77596.933	8081.568	5.604	434853.212532
K20	77613.192	8077.475	-14.396	-1117319.512032
合計				-360.333388
合計面積				180.1666940
地積				180.16 m ²

地番 ⑧ 17-12				
NO	Xn	Yn	Yn+1-Yn-1	Xn · (Yn+1-Yn-1)
K42	77597.153	8025.406	-13.996	-1086049.753388
K41	77586.397	8025.521	2.256	175034.911632
K40	77584.285	8027.662	14.003	1086412.742855
K39	77584.292	8039.524	11.855	919761.781660
K43	77597.162	8039.517	-14.118	-1095516.733116
合計				-357.050357
合計面積				178.5251785
地積				178.52 m ²

地番 ⑨ 17-13				
NO	Xn	Yn	Yn+1-Yn-1	Xn · (Yn+1-Yn-1)
K43	77597.162	8039.517	-5.051	-391943.265262
K39	77584.292	8039.524	13.015	1009759.560380
K38	77584.300	8052.532	13.001	1008673.484300
K45	77597.169	8052.525	-7.957	-617440.673733
K44	77597.165	8044.575	-13.008	-1009383.922320
合計				-334.816635
合計面積				167.4083175
地積				167.40 m ²

地番 ⑩ 17-14				
NO	Xn	Yn	Yn+1-Yn-1	Xn · (Yn+1-Yn-1)
K45	77597.169	8052.525	-12.470	-967636.697430
K38	77584.300	8052.532	13.286	1030785.009800
K37	77584.308	8065.811	15.118	1172919.568344
K36	77586.683	8067.650	-0.809	-62767.626547
K35	77597.177	8065.002	-15.125	-1173657.302125
合計				-357.047958
合計面積				178.5239790
地積				178.52 m ²

地番 ⑪ 17-15				
NO	Xn	Yn	Yn+1-Yn-1	Xn · (Yn+1-Yn-1)
K18	77594.488	8071.871	-5.614	-435615.455632
K15	77578.306	8075.954	14.830	1150486.277980
K16	77578.309	8086.701	9.376	727374.225184
S7	77581.972	8085.330	-5.133	-398228.262276
K17	77596.933	8081.568	-13.459	-1044377.121247
合計				-360.335991
合計面積				180.1679955
地積				180.16 m ²

地番 ⑫ 17-16				
NO	Xn	Yn	Yn+1-Yn-1	Xn · (Yn+1-Yn-1)
K2	77576.190	8025.594	2.106	163375.456140
K3	77578.279	8027.758	17.059	1323407.861461
K5	77578.291	8042.653	14.902	1156071.692482
K4	77566.973	8042.660	-17.001	-1318716.107973
K1	77566.824	8025.652	-17.066	-1323755.418384
合計				383.483726
合計面積				191.7418630
地積				191.74 m ²

地番 ⑬ 17-17				
NO	Xn	Yn	Yn+1-Yn-1	Xn · (Yn+1-Yn-1)
K5	77578.291	8042.653	-16.883	-1309754.286953
K4	77566.973	8042.660	16.890	1310106.173970
K6	77567.121	8059.543	16.883	1309565.703843
K7	77575.796	8059.543	0.000	0.000000
K8	77578.298	8059.543	-16.890	-1310297.453220
合計				-379.862360
合計面積				189.9311800
地積				189.93 m ²

地番 ⑭ 17-18				
NO	Xn	Yn	Yn+1-Yn-1	Xn · (Yn+1-Yn-1)
K13	77578.305	8069.952	-6.011	-466323.191355
K14	77567.213	8069.943	20.837	1616268.017281
S6	77567.396	8090.789	16.758	1299874.422168
K16	77578.309	8086.701	-14.835	-1150874.214015
K15	77578.306	8075.954	-16.749	-1299359.047194
合計				-414.013115
合計面積				207.0065575
地積				207.00 m ²

総合計面積 2556.428935 m²

地番	面積
① 17-5	169.5400955 m ²
② 17-6	165.2960260 m ²
③ 17-7	165.2944670 m ²
④ 17-8	203.0877710 m ²
⑤ 17-9	189.8681525 m ²
⑥ 17-10	189.8646165 m ²
⑦ 17-11	180.1666940 m ²
⑧ 17-12	178.5251785 m ²
⑨ 17-13	167.4083175 m ²
⑩ 17-14	178.5239790 m ²
⑪ 17-15	180.1679955 m ²
⑫ 17-16	191.7418630 m ²
⑬ 17-17	189.9311800 m ²
⑭ 17-18	207.0065575 m ²