

地積測量図 縮尺 1:400

魚津市慶野字水口
魚津市弥源寺字宮ノ前
魚津市住吉字三百歩

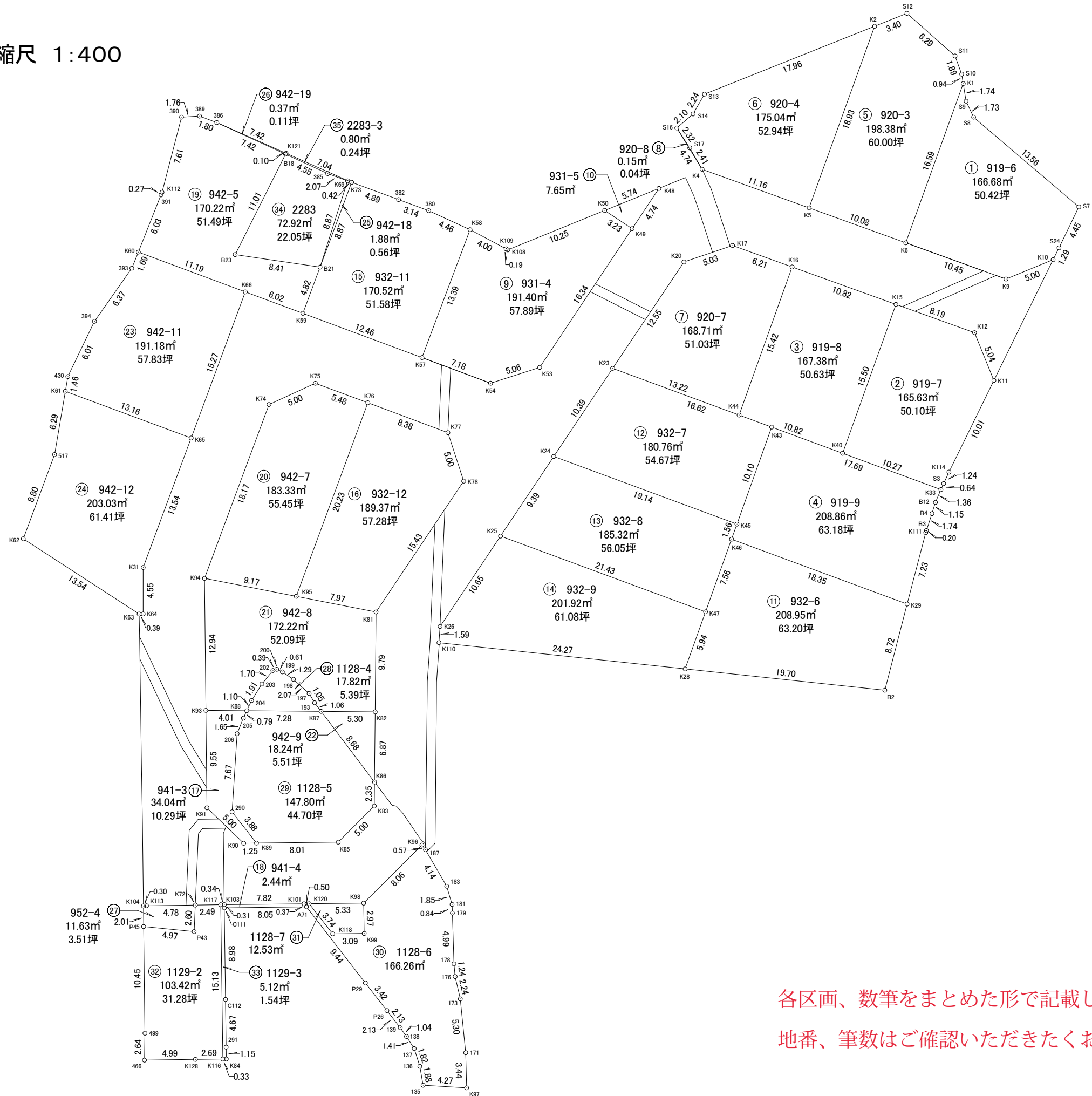

各区画、数筆をまとめた形で記載しております。
地番、筆数をご確認いただきたくお願いいたします。

求積表

地番	① 919-6			
NO	Xn	Yn	Yn+1-Yn-1	Xn · (Yn+1-Yn-1)
K1	221.348	123.181	-5.917	-1309.716116
K6	205.737	117.545	4.194	862.860978
K9	202.188	127.375	14.455	2922.627540
K10	204.088	132.000	5.201	1061.461688
S24	205.248	132.576	2.523	517.840704
S7	209.256	134.523	-8.375	-1752.519000
S8	218.056	124.201	-11.061	-2411.917416
S9	219.622	123.462	-1.020	-224.014440
合計				-333.376062
合計面積				166.6880310
地積				166.68 m ²

地番	② 919-7			
NO	Xn	Yn	Yn+1-Yn-1	Xn · (Yn+1-Yn-1)
K11	192.250	126.189	2.508	482.163000
K12	196.928	124.290	-9.606	-1891.690368
K15	199.705	116.583	-12.938	-2583.783290
K40	185.105	111.352	4.409	816.127945
K33	181.545	120.992	9.911	1799.292495
S3	182.134	121.263	0.790	143.885860
K114	183.261	121.782	4.926	902.743686
合計				-331.260672
合計面積				165.6303360
地積				165.63 m ²

地番	③ 919-8			
NO	Xn	Yn	Yn+1-Yn-1	Xn · (Yn+1-Yn-1)
K15	199.705	116.583	4.952	988.939160
K40	185.105	111.352	-15.385	-2847.840425
K44	188.854	101.198	-4.952	-935.205008
K16	203.372	106.400	15.385	3128.878220
合計				334.771947
合計面積				167.3859735
地積				167.38 m ²

地番	④ 919-9			
NO	Xn	Yn	Yn+1-Yn-1	Xn · (Yn+1-Yn-1)
K43	187.673	104.395	-20.005	-3754.398365
K45	178.160	100.987	-3.937	-701.415920
K46	176.682	100.458	16.687	2948.292534
K29	170.326	117.674	19.047	3244.199322
K111	177.330	119.505	1.899	336.749670
B3	177.527	119.573	0.607	107.758889
B4	179.183	120.112	0.881	157.860223
B12	180.291	120.454	0.880	158.656080
K33	181.545	120.992	-16.059	-2915.431155
合計				-417.728722
合計面積				208.8643610
地積				208.86 m ²

地番	⑤ 920-3			
NO	Xn	Yn	Yn+1-Yn-1	Xn · (Yn+1-Yn-1)
K1	221.348	123.181	-5.485	-1214.093780
K6	205.737	117.545	-15.118	-3110.331966
K5	209.160	108.063	-3.051	-638.147160
K2	226.973	114.494	9.597	2178.259881
S12	228.235	117.660	7.883	1799.176505
S11	224.059	122.377	5.370	1203.196830
S10	222.278	123.030	0.804	178.711512
合計				396.771822
合計面積				198.3859110
地積				198.38 m ²

地番	⑥ 920-4			
NO	Xn	Yn	Yn+1-Yn-1	Xn · (Yn+1-Yn-1)
K2	226.973	114.494	10.259	2328.516007
K5	209.160	108.063	-16.929	-3540.869640
K4	212.950	97.565	-11.703	-2492.153850
S17	215.045	96.360	-2.474	-532.021330
S16	216.997	95.091	0.324	70.307028
S14	218.372	96.684	2.713	592.443236
S13	220.318	97.804	17.810	3923.863580
合計				350.085031
合計面積				175.0425155
地積				175.04 m ²

地番	⑦ 920-7			
NO	Xn	Yn	Yn+1-Yn-1	Xn · (Yn+1-Yn-1)
K16	203.372	106.400	0.642	130.564824
K44	188.854	101.198	-17.605	-3324.774670
K23	193.433	88.795	-5.410	-1046.472530
K20	203.860	95.788	11.761	2397.597460
K17	205.477	100.556	10.612	2180.521924
合計				337.437008
合計面積				168.7185040
地積				168.71 m ²

地番	⑧ 920-8			
NO	Xn	Yn	Yn+1-Yn-1	Xn · (Yn+1-Yn-1)
S16	216.997	95.091	1.205	261.481385
K4	212.950	97.565	1.269	270.233550
S17	215.045	96.360	-2.474	-532.021330
合計				-0.306395
合計面積				0.1531975
地積				0.15 m ²

地番	⑨ 931-4			
NO	Xn	Yn	Yn+1-Yn-1	Xn · (Yn+1-Yn-1)
K50	208.911	88.015	12.194	2547.460734
K49	207.126	90.707	-6.371	-1319.599746
K53	193.526	81.644	-13.884	-2686.914984
K54	191.973	76.823	-11.550	-2217.288150
K57	194.488	70.094	-2.015	-391.893320
K58	207.028	74.808	8.251	1708.188028
K109	205.148	78.345	3.705	760.073340
K108	205.045	78.513	9.670	1982.785150
合計				382.811052
合計面積				191.4055260
地積				191.40 m ²

地番	⑩ 931-5			
NO	Xn	Yn	Yn+1-Yn-1	Xn · (Yn+1-Yn-1)
K49	207.126	90.707	5.319	1101.703194
K48	211.075	93.334	-2.692	-568.213900
K50	208.911	88.015	-2.627	-548.809197
合計				-15.319903
合計面積				7.6599515
地積				7.65 m ²

地番	⑪ 932-6			
NO	Xn	Yn	Yn+1-Yn-1	Xn · (Yn+1-Yn-1)
K29	170.326	117.674	15.033	2560.510758
B2	161.880	115.491	-21.773	-3524.613240
K28	163.965	95.901	-17.584	-2883.160560
K47	169.563	97.907	4.557	772.698591
K46	176.682	100.458	19.767	3492.473094
合計				417.908643
合計面積				208.9543215
地積				208.95 m ²

地番	⑫ 932-7			
NO	Xn	Yn	Yn+1-Yn-1	Xn · (Yn+1-Yn-1)
K43	187.673	104.395	0.211	39.599003
K44	188.854	101.198	-15.600	-2946.122400
K23	193.433	88.795	-18.175	-3515.644775
K24	184.793	83.023	12.192	2252.996256
K45	178.160	100.987	21.372	3807.635520
合計				-361.536396
合計面積				180.7681980
地積				180.76 m ²

地番	⑬ 932-8			
NO	Xn	Yn	Yn+1-Yn-1	Xn · (Yn+1-Yn-1)
K45	178.160	100.987	17.435	3106.219600
K46	176.682	100.458	-3.080	-544.180560
K47	169.563	97.907	-22.661	-3842.467143
K25	176.987	77.797	-14.884	-2634.274508
K24	184.793	83.023	23.190	4285.349670
合計				370.647059
合計面積				185.3235295
地積				185.32 m ²

地番	⑭ 932-9			
NO	Xn	Yn	Yn+1-Yn-1	Xn · (Yn+1-Yn-1)
K25	176.987	77.797	26.040	4608.741480
K47	169.563	97.907	18.104	3069.768552
K28	163.965	95.901	-26.149	-4287.520785
K110	166.534	71.758	-24.034	-4002.478156
K26	168.129	71.867	6.039	1015.331031
合計				403.842122
合計面積				201.9210610
地積				201.92 m ²

地番	⑮ 932-11			
NO	Xn	Yn	Yn+1-Yn-1	Xn · (Yn+1-Yn-1)
K58	207.028	74.808	-0.657	-136.017396
K57	194.488	70.094	-16.397	-3189.019736
K59	198.829	58.411	-6.897	-1371.323613
K73	211.666	63.197	9.385	1986.485410
382	209.980	67.796	7.554	1586.188920
380	208.889	70.751	7.012	1464.729668
合計				341.043253
合計面積				170.5216265
地積				170.52 m ²

地番	⑩ 932-12			
NO	Xn	Yn	Yn+1-Yn-1	Xn · (Yn+1-Yn-1)
K76	190.059	64.783	14.874	2826.937566
K77	187.129	72.635	9.404	1759.761116
K78	182.374	74.187	-7.047	-1285.189578
K81	169.551	65.588	-16.426	-2785.044726
K95	171.084	57.761	-0.805	-137.722620
合計				378.741758
合計面積				189.3708790
地積				189.37 m ²

地番	⑪ 941-3			
NO	Xn	Yn	Yn+1-Yn-1	Xn · (Yn+1-Yn-1)
K88	159.865	52.913	3.675	587.503875
205	159.143	52.574	-0.953	-151.663279
206	157.610	51.960	-1.107	-174.474270
290	149.952	51.467	1.903	285.358656
K89	146.893	53.863	1.139	167.311127
K90	146.879	52.606	-4.861	-713.978819
K91	150.347	49.002	-3.707	-557.336329
K93	159.901	48.899	3.911	625.372811
合計				68.093772
合計面積				34.0468860
地積				34.04 m ²

地番	⑫ 941-4			
NO	Xn	Yn	Yn+1-Yn-1	Xn · (Yn+1-Yn-1)
K103	140.856	50.699	-7.823	-1101.916488
C111	140.540	50.704	8.062	1133.033480
A71	140.643	58.761	7.823	1100.250189
K101	140.940	58.527	-8.062	-1136.258280
合計				-4.891099
合計面積				2.4455495
地積				2.44 m ²

地番	⑬ 942-5			
NO	Xn	Yn	Yn+1-Yn-1	Xn · (Yn+1-Yn-1)
B21	203.354	60.098	6.641	1350.473914
K59	198.829	58.411	-7.332	-1457.814228
K66	200.925	52.766	-16.137	-3242.326725
K60	204.829	42.274	-8.270	-1693.935830
391	210.438	44.496	2.323	488.847474
K112	210.692	44.597	2.013	424.122996
390	218.059	46.509	3.678	802.021002
389	218.162	48.275	3.460	754.840520
386	217.528	49.969	8.440	1835.936320
B18	214.428	56.715	1.801	386.184828
B23	204.582	51.770	3.383	692.100906
合計				340.451177
合計面積				170.2255885
地積				170.22 m ²

地番	⑭ 942-7			
NO	Xn	Yn	Yn+1-Yn-1	Xn · (Yn+1-Yn-1)
K76	190.059	64.783	-1.875	-356.360625
K95	171.084	57.761	-16.023	-2741.278932
K94	172.847	48.760	-2.672	-461.847184
K74	189.887	55.089	10.876	2065.211012
K75	191.969	59.636	9.694	1860.947486
合計				366.671757
合計面積				183.3358785
地積				183.33 m ²

地番	⑮ 942-8			
NO	Xn	Yn	Yn+1-Yn-1	Xn · (Yn+1-Yn-1)
K81	169.551	65.588	7.745	1313.172495
K82	159.755	65.506	-5.387	-860.600185
K87	159.802	60.201	-5.948	-950.502296
193	160.653	59.558	-1.176	-188.927928
197	161.560	59.025	-2.081	-336.206360
198	162.949	57.477	-2.622	-427.252278
199	163.672	56.403	-1.633	-267.276376
200	163.928	55.844	-0.933	-152.944824
202	163.807	55.470	-1.450	-237.520150
203	162.489	54.394	-2.086	-338.952054
204	160.867	53.384	-1.481	-238.244027
K88	159.865	52.913	-4.485	-716.994525
K93	159.901	48.899	-4.153	-664.068853
K94	172.847	48.760	8.862	1531.770114
K95	171.084	57.761	16.828	2879.001552
合計				344.454305
合計面積				172.2271525
地積				172.22 m ²

地番	⑯ 942-9			
NO	Xn	Yn	Yn+1-Yn-1	Xn · (Yn+1-Yn-1)
K87	159.802	60.201	0.068	10.866536
K82	159.755	65.506	5.237	836.636935
K86	152.878	65.438	-5.305	-811.017790
合計				36.485681
合計面積				18.2428405
地積				18.24 m ²

地番	⑰ 942-11			
NO	Xn	Yn	Yn+1-Yn-1	Xn · (Yn+1-Yn-1)
K66	200.925	52.766	5.181	1040.992425
K65	186.605	47.455	-17.654	-3294.324670
K61	191.182	35.112	-12.097	-2312.728654
430	192.628	35.358	2.858	550.530824
394	198.044	37.970	6.276	1242.924144
393	203.256	41.634	4.304	874.813824
K60	204.829	42.274	11.132	2280.156428
合計				382.364321
合計面積				191.1821605
地積				191.18 m ²

地番	⑱ 942-12			
NO	Xn	Yn	Yn+1-Yn-1	Xn · (Yn+1-Yn-1)
K61	191.182	35.112	-13.398	-2561.456436
517	184.979	34.057	-4.125	-763.038375
K62	176.722	30.987	8.296	1466.085712
K63	169.349	42.353	11.756	1990.866844
K64	169.356	42.743	0.393	66.556908
K31	173.907	42.746	4.712	819.449784
K65	186.605	47.455	-7.634	-1424.542570
合計				-406.078133
合計面積				203.0390665
地積				203.03 m ²

地番	⑲ 942-18			
NO	Xn	Yn	Yn+1-Yn-1	Xn · (Yn+1-Yn-1)
K69	211.812	62.799	3.099	656.405388
K73	211.666	63.197	-2.701	-571.709866
B21	203.354	60.098	-0.398	-80.934892
合計				3.760630
合計面積				1.8803150
地積				1.88 m ²

地番	⑳ 942-19			
NO	Xn	Yn	Yn+1-Yn-1	Xn · (Yn+1-Yn-1)
386	217.528	49.969	0.045	9.788760
K121	214.518	56.760	6.746	1447.138428
B18	214.428	56.715	-6.791	-1456.180548
合計				0.746640
合計面積				0.3733200
地積				0.37 m ²

地番	㉑ 952-4			
NO	Xn	Yn	Yn+1-Yn-1	Xn · (Yn+1-Yn-1)
K72	140.814	47.859	4.673	658.023822
P43	138.213	47.747	-5.062	-699.634206
P45	138.707	42.797	-4.975	-690.067325
K104	140.724	42.772	0.277	38.980548
K113	140.744	43.074	5.087	715.964728
合計				23.267567
合計面積				11.6337835
地積				11.63 m ²

地番	㉒ 1128-4			
NO	Xn	Yn	Yn+1-Yn-1	Xn · (Yn+1-Yn-1)
200	163.928	55.844	-0.933	-152.944824
202	163.807	55.470	-1.450	-237.520150
203	162.489	54.394	-2.086	-338.952054
204	160.867	53.384	-1.481	-238.244027
K88	159.865	52.913	6.817	1089.799705
K87	159.802	60.201	6.645	1061.884290
193	160.653	59.558	-1.176	-188.927928
197	161.560	59.025	-2.081	-336.206360
198	162.949	57.477	-2.622	-427.252278
199	163.672	56.403	-1.633	-267.276376
合計				-35.640002
合計面積				17.8200010
地積				17.82 m ²

地番	㉓ 1128-5			
NO	Xn	Yn	Yn+1-Yn-1	Xn · (Yn+1-Yn-1)
K88	159.865	52.913	-7.627	-1219.290355
205	159.143	52.574	-0.953	-151.663279
206	157.610	51.960	-1.107	-174.474270
290	149.952	51.467	1.903	285.358656
K89	146.893	53.863	10.411	1529.303023
K85	146.981	61.878	11.552	1697.924512
K83	150.524	65.415	3.560	535.865440
K86	152.878	65.438	-5.214	-797.105892
K87	159.802	60.201	-12.525	-2001.520050
合計				-295.602215
合計面積				147.8011075
地積				147.80 m ²

地番 ㊸ 1128-6				
NO	Xn	Yn	Yn+1-Yn-1	Xn · (Yn+1-Yn-1)
K98	141.003	64.371	5.658	797.794974
K96	146.696	70.085	6.064	889.564544
187	146.240	70.435	2.435	356.094400
183	142.661	72.520	2.612	372.630532
181	140.879	73.047	0.557	78.469603
179	140.036	73.077	0.183	25.626588
178	135.046	73.230	0.268	36.192328
176	133.804	73.345	0.623	83.359892
173	131.619	73.853	1.040	136.883760
171	126.342	74.385	0.619	78.205698
K97	122.896	74.472	-4.182	-513.951072
135	123.154	70.203	-4.591	-565.400014
136	125.010	69.881	-0.872	-109.008720
137	126.745	69.331	-1.305	-165.402225
138	127.938	68.576	-1.368	-175.019184
139	128.790	67.963	-1.923	-247.663170
P26	130.471	66.653	-3.418	-445.949878
P29	133.176	64.545	-7.892	-1051.024992
A71	140.643	58.761	-6.018	-846.389574
K101	140.940	58.527	0.271	38.194740
K120	140.946	59.032	2.809	395.917314
K118	137.996	61.336	5.395	744.488420
K99	138.029	64.427	3.035	418.918015
合計				332.531979
合計面積				166.2659895
地積				166.26 m ²

地番 ㊹ 1128-7				
NO	Xn	Yn	Yn+1-Yn-1	Xn · (Yn+1-Yn-1)
K120	140.946	59.032	3.035	427.771110
K98	141.003	64.371	5.395	760.711185
K99	138.029	64.427	-3.035	-418.918015
K118	137.996	61.336	-5.395	-744.488420
合計				25.075860
合計面積				12.5379300
地積				12.53 m ²

地番 ㊺ 1129-2				
NO	Xn	Yn	Yn+1-Yn-1	Xn · (Yn+1-Yn-1)
K72	140.814	47.859	2.608	367.242912
K117	140.851	50.355	2.708	381.424508
K116	125.722	50.567	-2.484	-312.293448
K128	125.686	47.871	-7.694	-967.028084
466	125.612	42.873	-4.950	-621.779400
499	128.252	42.921	-0.076	-9.747152
P45	138.707	42.797	4.826	669.399982
P43	138.213	47.747	5.062	699.634206
合計				206.853524
合計面積				103.4267620
地積				103.42 m ²

地番 ㊻ 1129-3				
NO	Xn	Yn	Yn+1-Yn-1	Xn · (Yn+1-Yn-1)
K117	140.851	50.355	-0.132	-18.592332
K116	125.722	50.567	0.545	68.518490
K84	125.727	50.900	0.317	39.855459
291	126.884	50.884	-0.078	-9.896952
C112	131.559	50.822	-0.180	-23.680620
C111	140.540	50.704	-0.123	-17.286420
K103	140.856	50.699	-0.349	-49.158744
合計				-10.241119
合計面積				5.1205595
地積				5.12 m ²

地番 ㊼ 2283				
NO	Xn	Yn	Yn+1-Yn-1	Xn · (Yn+1-Yn-1)
B18	214.428	56.715	-9.080	-1947.006240
B23	204.582	51.770	3.383	692.100906
B21	203.354	60.098	11.029	2242.791266
K69	211.812	62.799	0.752	159.282624
385	212.527	60.850	-6.084	-1293.014268
合計				-145.845712
合計面積				72.9228560
地積				72.92 m ²

地番 ㊽ 2283-3				
NO	Xn	Yn	Yn+1-Yn-1	Xn · (Yn+1-Yn-1)
K121	214.518	56.760	6.482	1390.505676
K73	211.666	63.197	4.090	865.713940
385	212.527	60.850	-6.482	-1377.600014
B18	214.428	56.715	-4.090	-877.010520
合計				1.609082
合計面積				0.8045410
地積				0.80 m ²

総合計面積	4102.1262100 m ²
-------	-----------------------------

地番	面積
① 919-6	166.6880310 m ²
② 919-7	165.6303360 m ²
③ 919-8	167.3859735 m ²
④ 919-9	208.8643610 m ²
⑤ 920-3	198.3859110 m ²
⑥ 920-4	175.0425155 m ²
⑦ 920-7	168.7185040 m ²
⑧ 920-8	0.1531975 m ²
⑨ 931-4	191.4055260 m ²
⑩ 931-5	7.6599515 m ²
⑪ 932-6	208.9543215 m ²
⑫ 932-7	180.7681980 m ²
⑬ 932-8	185.3235295 m ²
⑭ 932-9	201.9210610 m ²
⑮ 932-11	170.5216265 m ²
⑯ 932-12	189.3708790 m ²
⑰ 941-3	34.0468860 m ²
⑱ 941-4	2.4455495 m ²
⑲ 942-5	170.2255885 m ²
⑳ 942-7	183.3358785 m ²
㉑ 942-8	172.2271525 m ²
㉒ 942-9	18.2428405 m ²
㉓ 942-11	191.1821605 m ²
㉔ 942-12	203.0390665 m ²
㉕ 942-18	1.8803150 m ²
㉖ 942-19	0.3733200 m ²
㉗ 952-4	11.6337835 m ²
㉘ 1128-4	17.8200010 m ²
㉙ 1128-5	147.8011075 m ²
㉚ 1128-6	166.2659895 m ²
㉛ 1128-7	12.5379300 m ²
㉜ 1129-2	103.4267620 m ²
㉝ 1129-3	5.1205595 m ²
㉞ 2283	72.9228560 m ²
㉟ 2283-3	0.8045410 m ²